

**BLUEZONE**  
Perimeter Sealant Tape

**Installation  
Instructions**

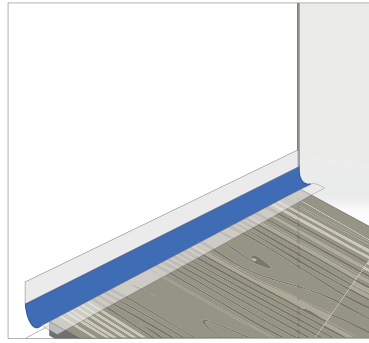

1. Apply tape to floor, lining up blue field with edge of flooring, meeting the corner with a square cut end.  
- Then press & seal bottom adhesive edge to floor.

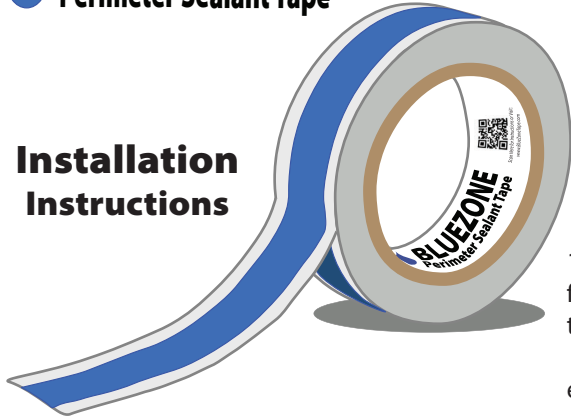
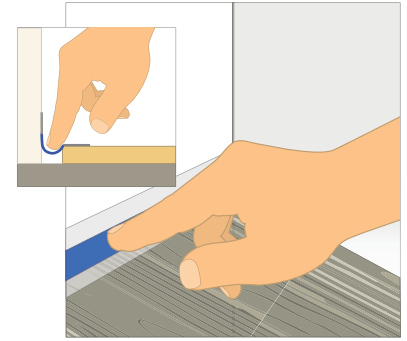

2. Using your fingers, press a "valley" into the flooring expansion space.  
- Then press & seal top adhesive edge to wall.

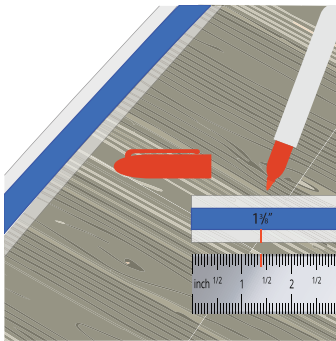

3. On a new section from the tape roll, make a mark 1-3/8" from end as shown.

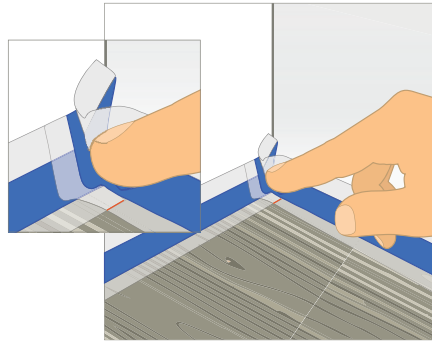

4. Line up mark with edge of tape as shown. Press and seal from the red mark, into the valley and up wall as shown.  
- Continue rolling out tape following step 1 and 2.

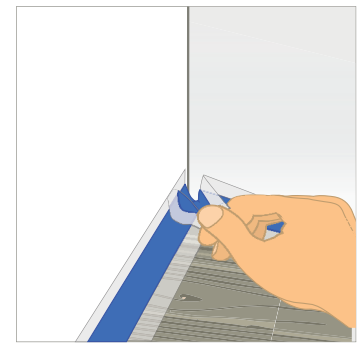

5. Pull tape corner out as shown and press the upper adhesive strip straight into the corner.  
**Note that the tape will not lay flat against the wall until you have equal valleys on both sides.**

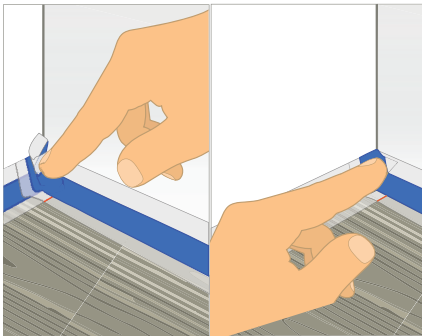

6. Pinch and press resulting flap in the corner flat against wall. Trim with scissors if needed.  
- If there are any bulges in adhesive strip, repeat step 5.

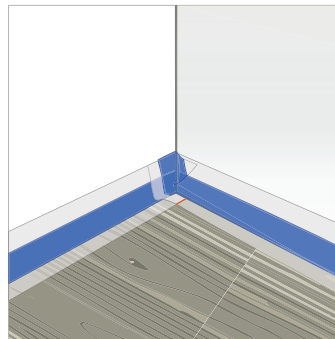

7. When tape strip is flat against wall, press and seal the upper adhesive strip.

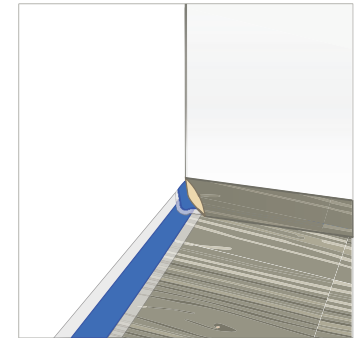

8. You are finished!  
Place molding as you normally would.

Placement of the tape may vary depending on the width of your flooring expansion space and the thickness of your molding.

For example, with a wide expansion space and a narrow baseboard, line the edge of the green zone a small distance away from the edge of the flooring, so that the tape does not show after molding is placed. See example on right.

The instructions above are set for 1/4" and 3/8" expansion space and a 3/4" or wider molding. So always test tape placement by setting a piece of molding on the first portion of tape you lay, and adjust step 1. above accordingly.

